

## Property Online Map

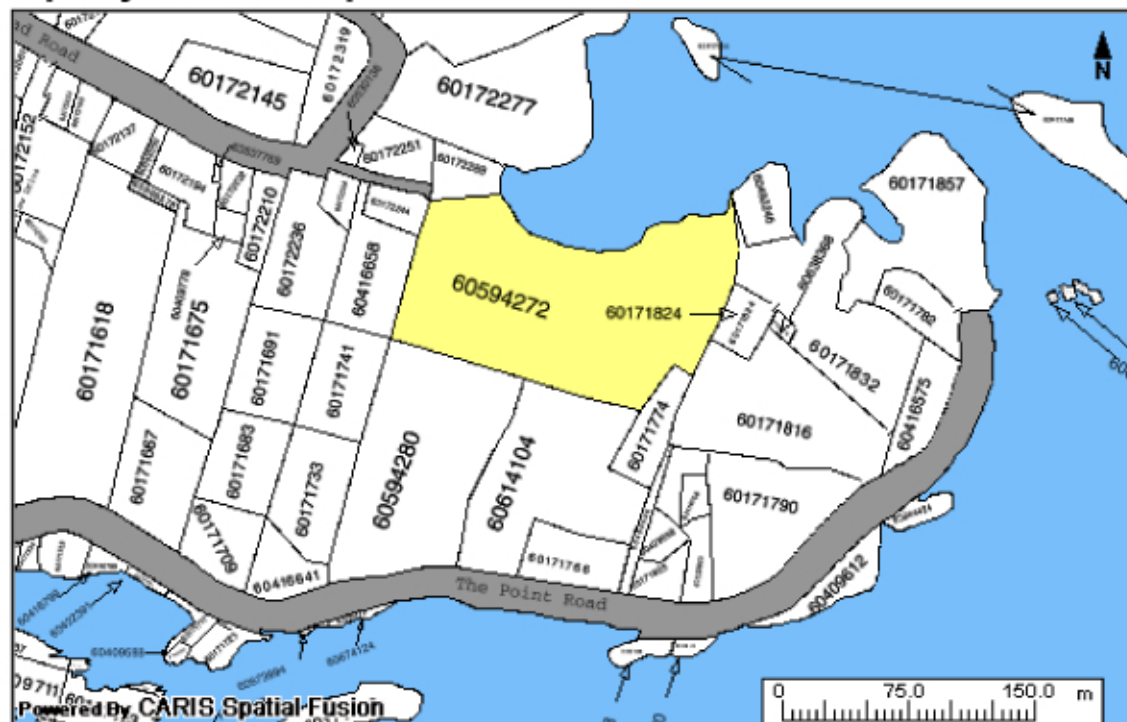

PID:	60594272	Address:	THE POINT ROAD	AAN:	09188061
County:	LUNENBURG COUNTY		BLUE ROCKS	Value:	\$225,000 (2018 RESIDENTIAL TAXABLE)
LR Status:	LAND REGISTRATION				

The Provincial mapping is a graphical representation of property boundaries which approximate the size, configuration and location of parcels. Care has been taken to ensure the best possible quality, however, this map is not a land survey and is not intended to be used for legal descriptions or to calculate exact dimensions or area. The Provincial mapping is not conclusive as to the location, boundaries or extent of a parcel [*Land Registration Act* subsection 21(2)]. THIS IS NOT AN OFFICIAL RECORD.

## Property Online version 2.0

This page and all contents are copyright © 1999-2003, [Government of Nova Scotia](#), all rights reserved.