

CERTIFICATE OF INSTALLATION

On-site sewage system as built construction details

Notification or Approval information: Notification number:
PID: Approval number:

Qualified Person (QP) or Professional Engineer Information

QP/P.Eng name:
Telephone: **Email:**
Installer name:
Telephone: **Email:**
Service provider: Name:
(for ATUs only) Email: Telephone:

Date of system completion:

This Certification of Installation must be submitted no later than 15 days after system completion in accordance with the *On-site Sewage Disposal Systems Regulations*.

I confirm that (select one):

- The system has been completed according to the *On-site Sewage Disposal System Regulations, Standard*, and the associated notification or approval, and final cover and seed or sod has been installed prior to the submission of this Certificate of Installation.
- The system has been completed according to the *On-site Sewage Disposal System Regulations, Standard*, and the associated notification or approval but final cover and/or seed or sod cannot be completed prior to the submission of this Certificate of Installation. The system has been protected from erosion and the Supplementary Final Cover Section of this form has been completed.

QP/P.Eng Name: **Signature:**

Eng/QP Cert#: **Date (d/m/y):**

CERTIFICATE OF INSTALLATION

On-site sewage system as built construction details

SITE PLAN

Site plan must include drawing of lot layout illustrating the location of the system installed, direction of and % slope, location of structures (proposed or existing), watercourse(s), well(s) and other confining features identified in the Standard including required clearance distances, in relation to the system location.

- Information must not include any personal identifying information.
- May include separate attachment for site plan.

System Details	
PID	60352564
Design flow (l/d)	1000
Intended use	Residential
System type	SSF
Trench length (m)	12.0
Trench width (m)	2.5
Sand speed (mins)	4 minute
Hydraulic Conductivity (m/s)	2×10^{-4} (m/s)

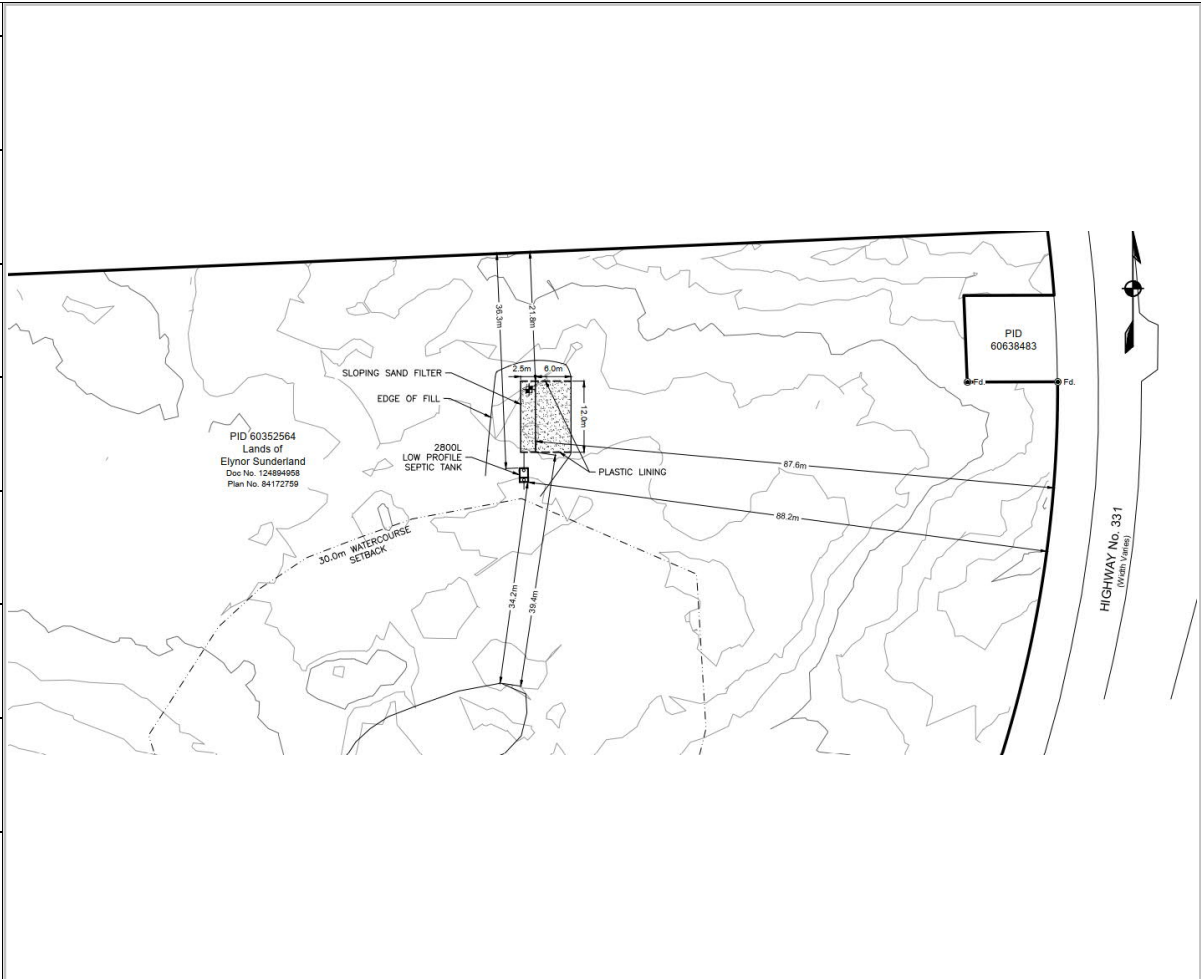

As built clearance distances as illustrated on site plan

From Nearest	To Field	To Tanks	From Nearest	To Field	To Tanks	From Nearest	To Field	To Tanks
Lot Boundary	21.8 m	36.3 m	Cistern	- m	- m	Water Distribution	- m	- m
Downslope Boundary	87.6 m	88.2 m	Watercourse	39.4 m	34.2 m	Foundation Drain	- m	- m
Drilled Well	- m	- m	Wetland	- m	- m	Other	- m	- m
Dug Well	- m	- m	Intermittent Drain	- m	- m	Other	- m	- m

Selection/Design notes (e.g. water filter backwash, greywater only system):

Plastic lining installed

CERTIFICATE OF INSTALLATION

On-site sewage system as built construction details

SUPPLEMENTARY SECTION

Only complete this section if the final cover/seed sod will not be completed prior to the submission of this Certificate of Installation.

At the time of submission of this Certificate of Installation the final cover and/or seed or sod was not installed over the completed system. This work is required by Section 50 of the *On-site Sewage Disposal Systems Standard*.

Final cover material

- 50** **(1)** A completed system must be covered with a layer of soil that will promote the growth of vegetation within the first growing season.
- (2)** The layer of soil covering a completed system must be seeded or sodded with grass or a similar shallow root vegetation to prevent erosion.

Complete only one:



Installer to complete final cover, seed, or sod

The installer has protected the completed system against erosion and, if necessary, freezing. All damage will be repaired by the installer prior to the installer placing the final cover material and/or sod or seeding as required by Section 50 of the *On-site Sewage Disposal Systems Standard*. This work will be completed within the current growing season or within the next growing season if the system was completed outside of the growing season.

Signature of Installer:

Date (d/m/y):

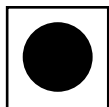

Lot Owner to complete final cover, seed, or sod

The installer has protected the completed system against erosion and, if necessary, freezing. The QP/P.Eng has informed the lot owner final cover, seed or sod is required under the *On-site Sewage Disposal Systems Standard* and must be completed within the current growing season or within the next growing season if the system was completed outside of the growing season. The lot owner has agreed to complete this work and understands that any damage to the system must be repaired by a certified installer prior to the placing of the final cover material.

Signature of QP/P.Eng.:

Date (d/m/y):