



MLS Client View - VACANT LAND

MLS #	5091007	Region	South Shore
PID #	60181559	County	Lunenburg
Additional PID		District	405-Lunenburg County
Type	Vacant Lot(s)	Sub-District	B3
Listing Status	ACTIVE	Lot Size	11.07 ACRES
Listing Price	\$159,900	Zoning	NONE
Selling Price		Road	
Address	LOT 1000 UPPER FIRST PENINSULA Road	Waterfront	No
Address 2			
Community	Lunenburg		

Directions to Property

Off Route 332, turn onto First Peninsula Rd, at the head of Lunenburg Back Harbour. Go 100 meters then veer to the left onto Upper First Peninsula Road. Follow Upper First Peninsula Road 1KM to the top of the hill and look for the realty sign posted on your right.

[Virt Tour URL](#)

Closing Date

General Property Information:

Prop Knwn As/Bdy of Water	LUNENBURG BACK HARBOUR	WATER ACCESS/VIEW	View: Harbour, View: Ocean	Elementary School	Bluenose Academy
Legal Description		Water Frontage Units		Middle/Jr School	
Title to Land	Freehold	Water Frontage Meas		High School	Park View Education Centre
Restr/Prot Covenants				Fr Imm Elementary School	
Survey				Fr Imm Middle/Jr School	
Current Valid Perc Test				Fr Imm High School	
Property Gated				Other	
Environmental Assessment					
Easements					
Assessment					
Assessment Year					
Association Fees					

Property Overview

Room to Roam...or farm, or build, or plant -- 11 pristine acres a stone`s throw from town! Mostly cleared pasture land with a gentle south-facing slope, a perimeter of mature trees, and a small brook running along its border. Several excellent building sites with partial views of Lunenburg over the waters of back harbour. Ideal aspect for passive solar home design. Quiet, private and undeveloped. Enjoy `Country Living` just minutes from the amenities of world-famous Lunenburg. Lot is surveyed and has excellent subdivision potential.

Property Features

PROPERTY SIZE	10 to 49.99 Acres	UTILITIES	Electricity, High Speed Internet, Telephone
WATER SOURCE	None	DRIVEWAY/PARKING	Dirt
SEWAGE DISPOSAL	None	LAND FEATURES	Cleared, Sloping/Terraced, Stream/Pond, Wooded /Treed, Year Round Road



CYNTHIA DIAL - Main: 902-298-0332
info@OceanHomesNovaScotia.com
 RED DOOR REALTY - 16940



Listing Office RED DOOR REALTY - 16940

MLS # 5091007
List Price \$159,900
Status ACT
Class: VL

Address LOT 1000 UPPER FIRST PENINSULA Road
Community LUNENBURG
Province NS
Postal Code B0J 2C0

Listing Office:
RED DOOR REALTY - 16940

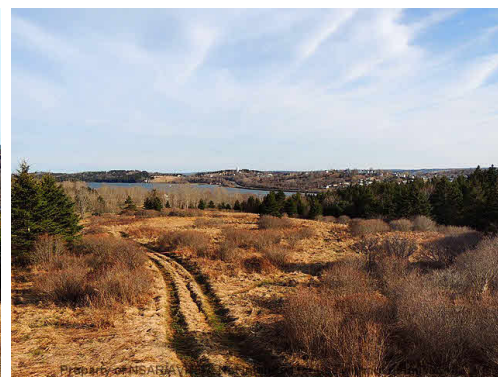
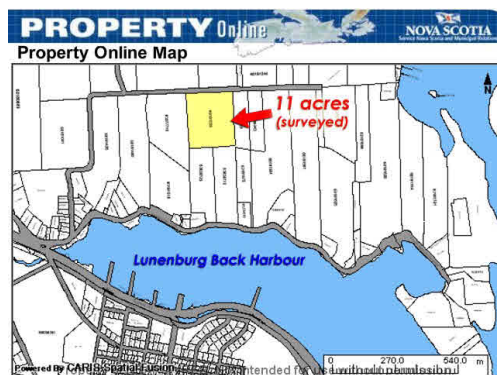



MLS # 5091007

PID # 60181559



Information on this site is distributed by the NSAR and the AVREB. The information provision and inputting of that information is done by members of NSAR and AVREB. NSAR & AVREB accepts no responsibility for its content and accuracy.